

Adjustable Mechanical Vacuum Switch

Compact, sealed vacuum switch for automation and process control applications

VSW5A Series



VSW5A – High amperage line voltage 120vAC

Ideal Applications:

- Hazardous applications
- Wash down applications
- Dust-laden air environment

Features/Benefits

- High amperage line voltage 120vAC
- Vacuum range 5" to 30"Hg [-170 to 1015mbar]
- Durable – Nema 6 Enclosure (IP67) protection for extremely dirty environments
- Flexible – field adjustable between vacuum ranges
- Easy to install – common electrical connection DIN 43650A
- Safe – UL and CSA Approved
- Versatile – can be wired for normally open or normally closed

Vacuum Switches:

Vaccon's VSW5A is a high-current capacity switch capable of switching line voltage loads from 5 Amps to 125 VAC. The sealed vacuum switch is field adjustable from 5 to 28"Hg [169 to 948 mbar]. The vacuum level adjustment screw is easily accessed below the DIN connector. Wiring can be either normally open or normally closed.

Adjustable Mechanical Vacuum Switch: VSW5A

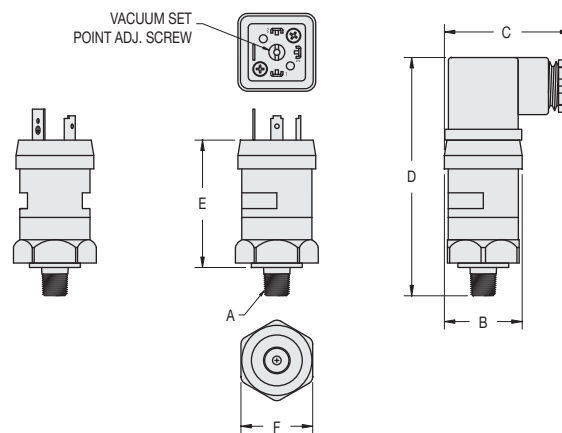

Model #	Dimensions							Weight
		A	B	C	D	E	F	
VSW5A	in.	1/8 NPT M	1.22	1.98	3.74	2.00	1.13	4.1 oz
	mm	1/8 NPT M	31.0	50.3	95.0	50.8	28.7	116 g

Please Note: VSW5A replaces VSW5A-1 and VSW5A-2

Wiring Schematic for VSW5A: Set Point Adjustment

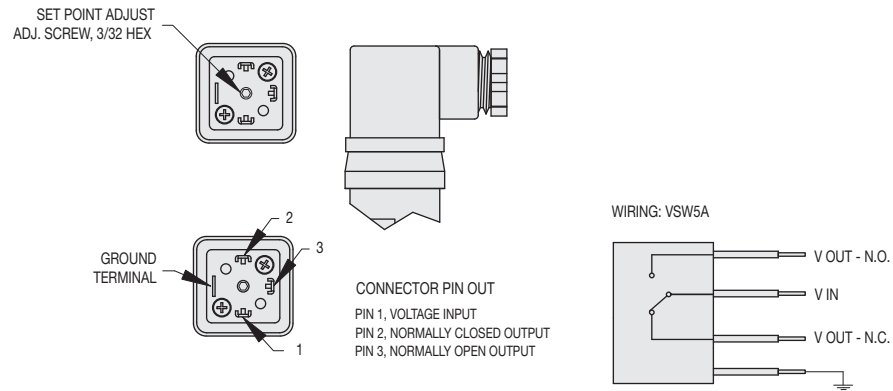

1. Remove center screw and DIN adaptor.
2. Place a 3/32" allen wrench into center hole.
3. Adjust counter-clockwise to increase set point, clockwise to decrease set point.
4. When desired setting is met, remove allen wrench and replace DIN adaptor and tighten screw.

VSW5A Specifications:

Rated Vacuum Range:	5" to 30" Hg [-170 to -1015 mbar]
Proof Pressure:	45 PSI [3.1 bar]
Burst Pressure:	350 PSI [24 bar]
Media:	Non-Corrosive, Dry Gases
Switch Type:	Nitrile Diaphragm
Sensing/Switching Material:	N/A
Output:	SPDT
Electrical Connection:	DIN 43650A
Hysteresis:	3" to 4" Hg [-102 mbar to -135 mbar]
Repeatability:	+/- 2% Full Scale
Max. Switched Voltage Load:	12/24 VDC, 125/250 VAC
Max. Switched Current Load:	5A for 12/24 VDC and 125 VAC, 3A - for 250 VAC
Display:	NONE
Switch Indication:	NONE
IP Protection:	IP65
Operating Temperature:	-20°F to 180°F [-28°C to 82°C]
Operating Humidity:	35 to 85% RH (No Condensation)
Mechanical Life:	100,000,000 Cycles
Construction:	Brass Housing, Nitrile Diaphragm
Fitting/Connection:	1/8" NPT Male
Weight:	4.0 oz. [113g]
Safety and Environmental Compliance:	UL, CSA, VDE and UR

How to Specify:

Order by part number: **VSW5A** (replaces VSW5A-1 and VSW5A-2)