

AA Series Silencers



AA Series silencers have excellent noise reducing characteristics with minimal resistance to air flow. AA Series silencers are one third smaller than comparable products, providing considerable space savings. The large surface of the felt element resists contamination far more than other materials such as sintered bronze, steel mesh or porous polyethylene.

Features:

- Compact
- Lightweight
- Durable
- 4 Thread sizes 1/8, 1/4, 3/8, 1/2
- Closed-end silencer

Benefits:

- Maximize performance – silences pneumatic equipment without back pressure.
- Increase productivity and operator safety – reduces irritating noise, improves working environment
- Closed-end silencer – contaminants can't escape
 - ~ maintains clean environment
 - ~ reduces maintenance costs
 - ~ increases equipment life

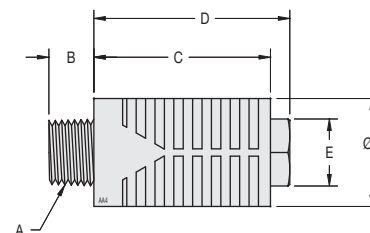

Model #		Dimensions						Weight	Construction				Noise Level
		A*	B	C	D	E	F		Body	Baffle	Screen	Element	
AA2	in.	1/8	0.23	0.97	1.08	0.39	0.61	0.1 oz	Nylon	Nylon	Nylon	Felt	58dB
	mm.		5.8	24.6	27.4	9.91	15.5						
AA4	in.	1/4	0.32	1.26	1.39	0.47	0.77	0.2 oz					
	mm.		8.1	32.0	35.3	11.94	19.6						6 g
AA6	in.	3/8	0.41	1.74	1.86	0.62	0.96	0.4 oz					
	mm.												[10.4]
AA8	in.	1/2	0.41	1.74	1.86	0.62	0.96	0.4 oz					
	mm.												[10.4]

*Fits NPT, BSPP and BSPT threads.

AA Series Silencers Operating Specifications:

Max. Operating Pressure: Not to exceed 150 PSI

Noise level: Measured 4.5 ft on the diagonal from the silencer while attached to a Vaccon pump. Noise levels will vary on Vaccon and non-Vaccon products.

Note 1: Vaccon strongly recommends the use of silencers on all vacuum pumps.

Note 2: Vaccon silencers are used on all types of pneumatic devices such as air-operated vacuum pumps, air motors, valves, cylinders and more.

How to Specify:

- **For Silencer only:** Order by Model #.
- **Vaccon pump/silencer combinations:** Vaccon pumps include a silencer(s) that has been sized to ensure maximum pump performance. See specific pump for silencer options.
- **Non-Vaccon pneumatic devices:** The thread size on the exhaust port of the pneumatic device determines the size of the silencer.
- Equipment and applications may vary. Consult factory for proper silencer selection.